



22 Christchurch Road

Ashford, TN23 7XB

Price £285,000

Attractive terraced home in a popular residential setting, just a few minutes walk from Ashford mainline station, town centre and Victoria Park.

The property comprises an entrance hall, sitting room, dining room, kitchen, ground floor bathroom and three bedrooms.

A new boiler was installed in 2024 whilst the property also enjoys double glazing and a very generous garden to the rear.

Offered for sale with no onward chain.

Viewing

Please contact our Ashford Office on 01233 646411 if you wish to arrange a viewing appointment for this property or require further information.

- WELL APPOINTED TERRACED HOME
- THREE BEDROOMS
- SITTING & DINING ROOM
- GROUND FLOOR BATHROOM/WC
- GENEROUS REAR GARDEN
- SHORT WALK FROM TOWN CENTRE & MAINLINE STATION
- GAS CENTRAL HEATING & DOUBLE GLAZING
- NO ONWARD CHAIN



Floor Plan

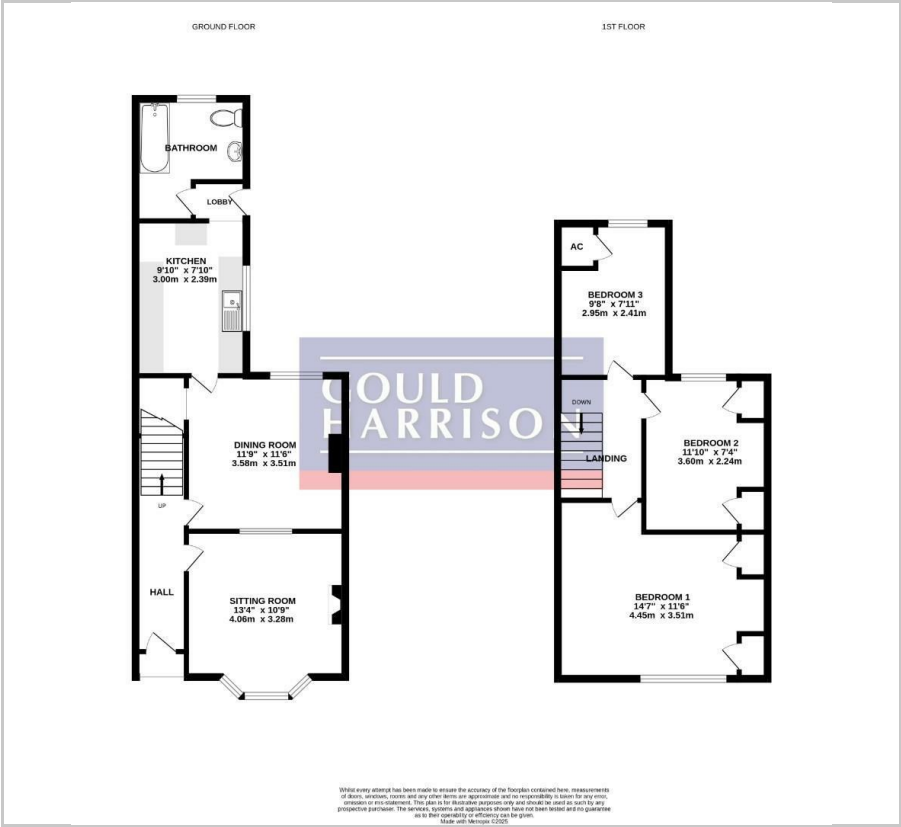

Area Map



Energy Efficiency Graph

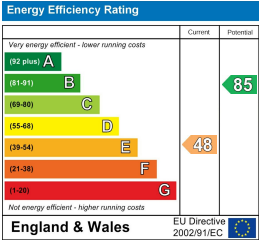

These particulars, whilst believed to be accurate are set out as a general outline only for guidance and do not constitute any part of an offer or contract. Intending purchasers should not rely on them as statements of representation of fact, but must satisfy themselves by inspection or otherwise as to their accuracy. No person in this firms employment has the authority to make or give any representation or warranty in respect of the property.